

# **STEERING-ASSISTED TILLER OUTBOARD MODELS**

## **F200/F150**

## **Yamaha Introduces Steering Assist to Tiller Handle Outboards**

New for 2025, Yamaha levels up tiller handle boating with the introduction of Steering Assist Tiller Handle F200 and F150 outboards.

Designed to provide natural, intuitive tiller operation for both novice and experienced captains alike, Yamaha's new Steering Assist Tiller Handle outboards give boaters more controlled maneuvering and added ride comfort.

Incorporating the electro-hydraulic steering system introduced in 2023, the new mechanical Steering Assist Tiller handle engages an electric steering sensor that triggers the outboard's integrated electro-hydraulic steering system. At or above 2000 RPM, the steering sensitivity can be set for lighter, effortless steering to reduce arm strain during long runs.

Steering sensitivity can also be set for increased tension creating tighter, traditional tiller arm feedback for more precision control during lower RPMs and when navigating chop.

With Yamaha's all new Steering Assist Tiller handle F200 and F150 outboards, boaters get premium tiller steering with more horsepower, an abundance of built-in features and benefits that come standard.



# STEERING-ASSISTED TILLER OUTBOARD MODELS

YAMAHA MARINE  
ENGINE SYSTEMS | **HOT SHEET**

To promote comfort and convenience for captains of various physical sizes and to accommodate different boat load scenarios, the new Steering Assist Tiller handle can be adjusted up to 15 degrees port or starboard from center in 5-degree increments, whereas the height adjustment screw allows the tiller arm to be raised or lowered parallel to the boat deck or captain's seat to modify according to captain seating preferences.

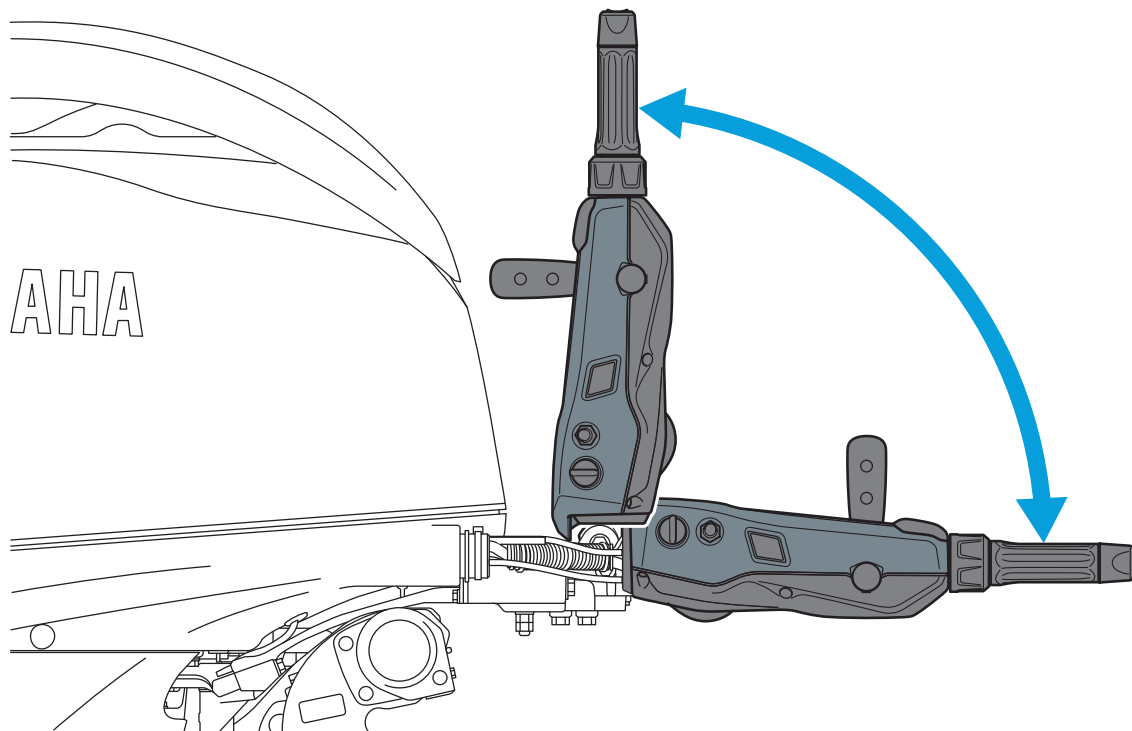
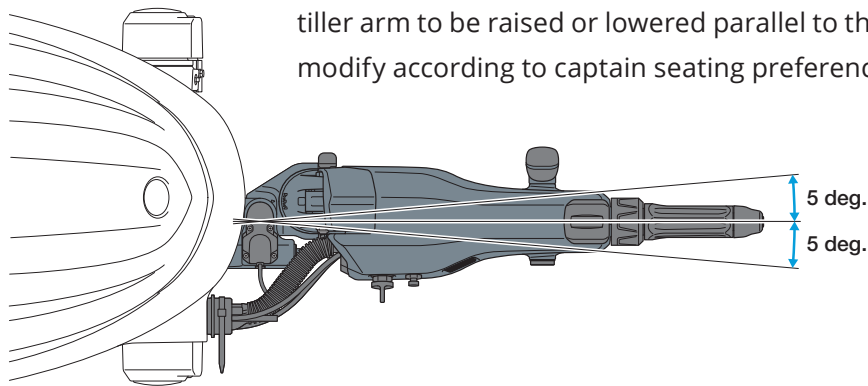

With the new Steering Assist Tiller Handle outboards, boaters reap the benefit of steering capability from end-to-end of the entire tiller arm, which means steering and quick shifting can be simultaneously accomplished from the shift lever or wherever the captain feels most comfortable placing his hand. The tiller arm can also be folded and locked vertically 90 degrees at its mounting base, allowing upright tiller arm steering during loading, and docking.

# STEERING-ASSISTED TILLER OUTBOARD MODELS

YAMAHA MARINE  
ENGINE SYSTEMS | **HOT SHEET**

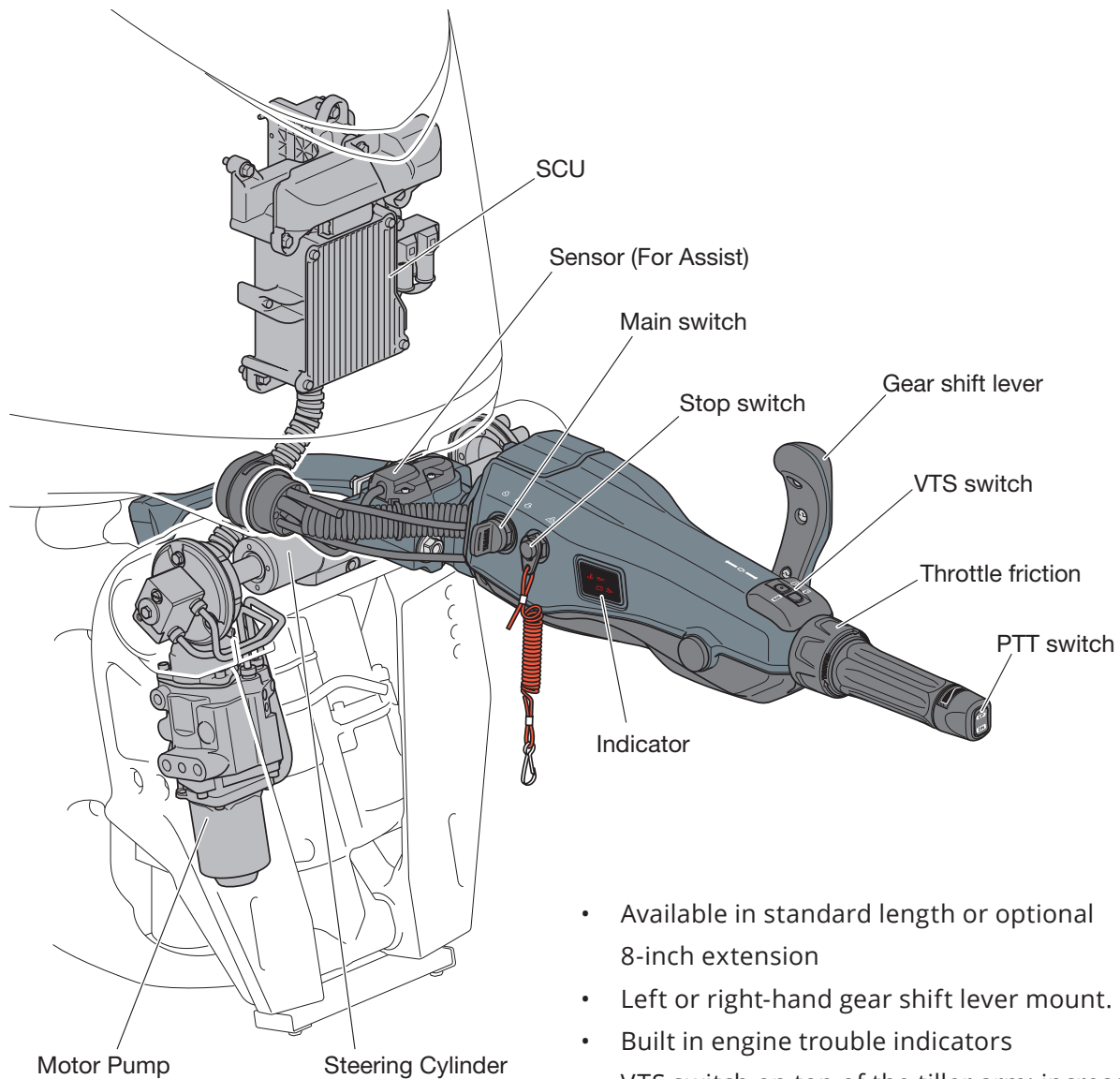

- Available in standard length or optional 8-inch extension
- Left or right-hand gear shift lever mount.
- Built in engine trouble indicators
- VTS switch on top of the tiller arm; increase or reduce engine RPM in 10% increments up to 800 RPM
- Throttle friction adjustment at the collar.
- PTT at the end of the handle (same orientation regardless of throttle position)

# STEERING-ASSISTED TILLER OUTBOARD MODELS

## FEATURES

- ECM control system
- Variable trolling RPM
- 50-Amp high output alternator
- Closed fuel vapor system
- Fuel vaporization control system
- Large water separator with water sensor

- Elegant, sleek, lightweight design
- Plastic lightweight bottom cowling
- Intake air draining system

- Bolted flywheel
- 16-valve, DOHC, In-line 4
- Multi-point electronic fuel injection
- Direct ignition
- Variable Camshaft Timing (VCT) (F200R)
- Offset cylinder
- Twin balance shaft
- Long intake manifold/ Precise single throttle
- Blow-by gas reburning system
- Tensioner
- 4 into 1 exhaust system

- NEW** Power assisted multi-function tiller handle
- Adapter interface with tilt limit
- Long span mounting system

- Special treatment strong gears
- Shift Dampener System (SDS)

- Labyrinth exhaust system
- Combined upper case with oil pan
- Long oil stick tube
- Water-sealed outer wall

### YAMAHA Ideal Anti-Corrosion System

Special aluminum alloy: YDC30	Self-sacrificing anodes	Freshwater flushing device
Electrodeposited inside/outside paint process	Anodic exhaust coating (alumite)	

### Warning & Protection

<b>WARNING</b> Over-heat warning	Over-rev limiter	<b>WARNING</b> Low oil pressure warning	Knock control
Fail-safe system	Yamaha Diagnostic System (YDIS)	Start-in-gear protection	YAMAHA immobilizer

# STEERING-ASSISTED TILLER OUTBOARD MODELS

Steering Assist Tiller Handle F200 and F150 models are equipped with a mechanical tiller arm that engages steering assist using the outboard engine's integrated electro-hydraulic steering system. Steering Assist Tiller Handle F200/F150 outboards are compatible with the following gauge options:

- CL5 or any Command Link® compatible tachometer
- Command Link connected to AGI for analog tachometer is optional
- Analog Gauges (AGI is not required for analog gauge operation, but it should be noted warning lights on the tiller handle will not be functional due to trip/oil harness running to the analog tachometer)



## STEERING-ASSIST TILLER HANDLE OUTBOARD MODELS

Steering-Assist Tiller Model Numbers	Availability*
F200XHA	Summer 2025
F150XHA	Summer 2025
6XA-42102-00**	Summer 2025
6XA-42102-10***	Summer 2025

\*Availability and dates are subject to change. The tiller handle is not an accessory and is not sold separately from the outboard.

\*\*Required rigging fit-kit for the standard length both horsepower sizes.

\*\*\*Includes the 8" extension and the fit kit for both horsepower sizes.

This document contains many of the valuable trademarks and service marks owned and used by Yamaha throughout the world. The document may also contain references to other company, brand and product names that may be the trademarks/service marks of their respective owners. These company, brand and product names are used herein for identification purposes only, and references to any names, marks, products or services of third parties do not constitute or imply endorsement, sponsorship or recommendation of the third party or the products or services. Information and data contained herein is approximate and subject to many different factors and variables, including but not limited to atmosphere, water, equipment conditions, and operator ability. It is provided as a guideline only and should not be relied upon as a representative of actual performance. Due to Yamaha's ongoing commitment to product improvement, we reserve the right to change without notice, equipment, availability, specifications, and prices. In the event demand exceeds supply, Yamaha within its sole discretion will fill orders based on an allocation method that provides for a fair distribution of products. Also, due to various factors, including the boat's actual weight and wind and water conditions, the product's performance may be different than the information contained herein. Please confirm the specifications and performance data on your specific boat/engine combination with your dealer prior to purchase.

**REMEMBER** to always observe all applicable boating laws. Never drink and drive. Dress properly with a USCG-approved personal flotation device and protective gear. Boat smart from the start. Take a boating safety course and get a free vessel safety check annually for your boat. For more information, contact: United States Coast Guard Auxiliary online at [www.cgaux.org](http://www.cgaux.org), or United States Power Squadrons at 888-for-usps or [www.usps.org](http://www.usps.org).

© 2025 Yamaha Motor Corporation, U.S.A. All rights reserved.